

# Jetson M1



Factsheet



**MUTE.**



# Jetson M1

A one-person pod, ideal as a tranquil spot for solo, hands-on work. A cozy, soundproof oasis where you can focus and get things done.

Jetson is a family of universal acoustic pods designed to make everyone's work joyful and fruitful. It's truly people-focused: comfortable and customizable through add-on sets to meet your need and vision. Made of extruded aluminum, which makes it the lightest and most environmentally-friendly pod on the market. With its durable construction, no-hassle assembly, effective sound attenuation, and attractive price, Jetson will introduce the benefits of acoustic pods to all.

## FUNCTION

---

Videocall or focused work

## ACOUSTICS

---

Insulation

## USAGE

---

Open space

Reception

Breakout area

Other public spaces

# Dimensions & weight

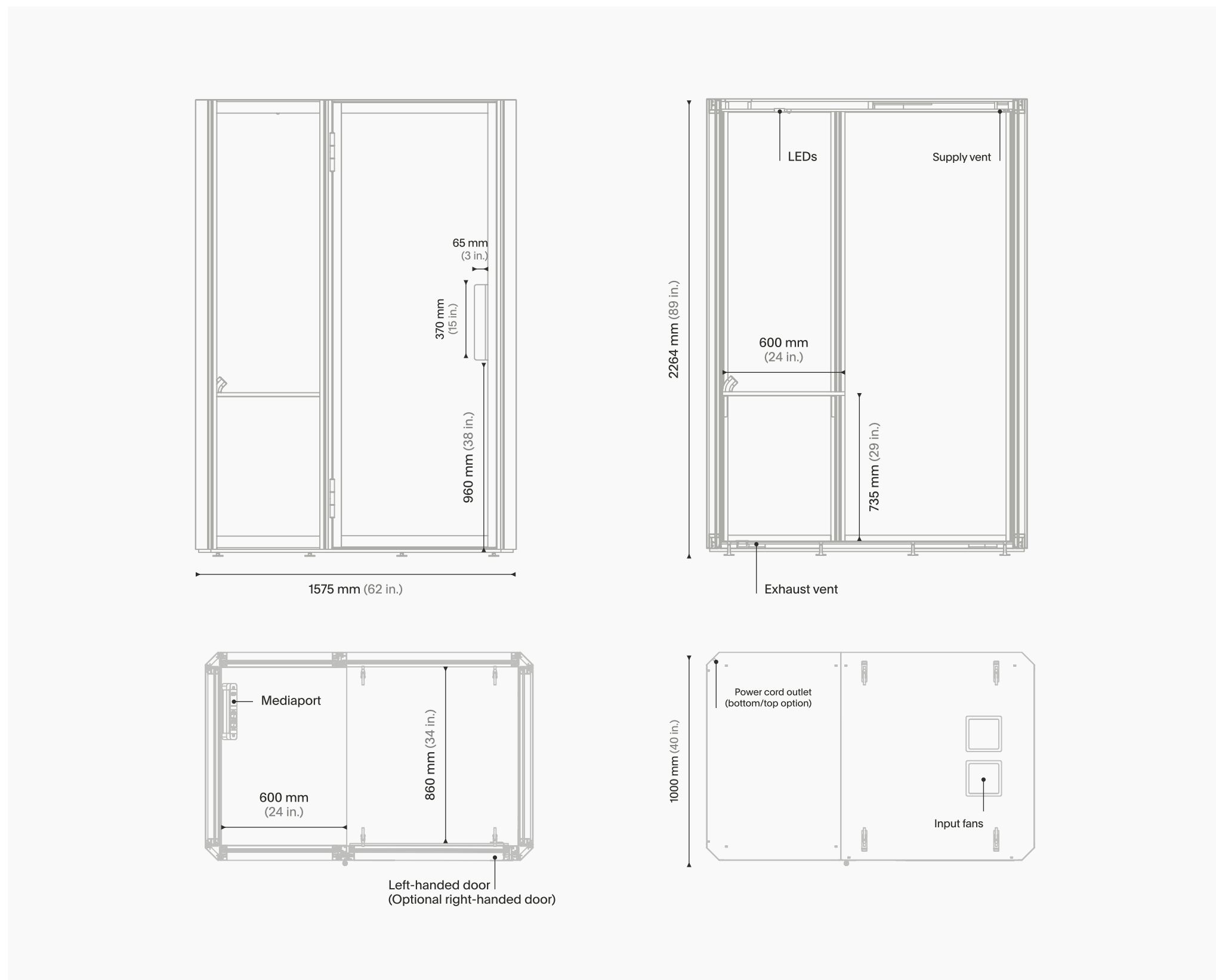

## Pod

DIMENSIONS	EXTERIOR / INTERIOR	WEIGHT	
Width	1575 mm (62 in.) / 1435 mm (56 in.)	Pod weight	275 kg (606 lbs)
Depth	1000 mm (40 in.) / 860 mm (34 in.) + 800 mm (32 in.) with an open door	Shipment weight	320 kg (706 lbs)
Height	2264 mm (89 in.) / 2102 mm (83 in.) + 36 mm (1.4 in.) with casters		

## Packing (cartboard flat-packs – 9 layers)

DIMENSIONS		WEIGHT	
Width	2270 mm (89 in.)	Wooden pallet	29 kg (64 lbs)
Depth	1270 mm (50 in.)	Plywood pallet	40 kg (88 lbs)
Height	960 mm (38 in.)		

### POSSIBILITY OF STOCKING

Number of pods	2
----------------	---

# Technical data

## ACOUSTIC RESULTS

Speech level reduction	$D_{S,A} = 26,5$ dB, class B, ISO 23351-1
Range of level reduction D	16,9–35,5 dB (125–8000 Hz)
Sound insulation	ISO 10140-2
• Glass wall (6 mm ESG)	$R_w = 33$ dB, $R_{A1} = 32$ dB
• Solid wall	$R_w = 38$ dB, $R_{A1} = 36$ dB
Reverberation time inside	0,2 s (250–4000 Hz) – ISO 354:2005

## POWER CONSUMPTION AND LIGHTING

Standby	5,7 W
Working (fan, LEDs)	40 W
Power supply voltage	220-240 VAC, 50-60 Hz
Light source	1416 mm LED strip
Brightness on the tabletop surface	400 lux
LED power consumption	Max 26,6 W
LED supply voltage	24 V DC
Color temperature / brightness	4000 K / 1980 lm/m
Light control	Occupancy sensor, auto start/stop

## COMPOSITION

- Aluminium structure and steel elements
- Plywood and melamine faced chipboard
- Isolating and absorbing materials
- Tempered glass
- Felt

## CERTIFICATES AND TESTS

- ISO 14001, ISO 9001
- VOC (PN-EN ISO 16000-9) and Formaldehyde (EN 717-1:2006) tested
- Formaldehyde (EN 717-1:2006) tested
- Speech reduction tested acc. to ISO 23351-1:2020
- Reaction to fire tested acc. to EN-13501-1:2018

## VENTILATION

System airflow	65 m <sup>3</sup> /h
Nominal airflow	365 m <sup>3</sup> /h
Air change rate (ACPH)	24 / h
Fan emitted noise outside	36 dBA
Fan emitted noise inside	38 dBA
Ventilation operation	Occupancy sensor, auto start/stop
Fan supply voltage	24 V DC

## MEDIA PORT (FPD UNIT)

Power supply voltage	220-240 VAC, 50-60 Hz
Power sockets in a mediaport	2
USB fast charger in a mediaport	TUF A+C 30 W
Max load of power sockets	10 A
Mounting system	Included, desk mount
LAN port	Possibility to route the LAN cable
Available socket types	FR / DE / UK / CH / AU / DK* / IT*

\*The appearance of the media port may differ from that shown in the renderings. Parameters and features remain unchanged.

## WARRANTY

We offer a 5-year warranty and a 5-year right to repair. What is more, Jetson is made entirely of easily replaceable components. So, if you ever do need to repair Jetson, it's quick, cheap, and simple.



0%  
Formaldehyde  
VOC tested



# Equipment

## STANDARD EQUIPMENT

- Ventilation system
- LED light 4000K
- Occupancy sensor
- Media port with 2 power and A+C USB sockets
- Wall-mounted tabletop and wall hook
- Display rail, phone holder and magnet
- Power cord 3 m (118 in.)

## ADDITIONAL EQUIPMENT

### + Monitor hanger

A flexible mounting system designed to accommodate screens of various sizes (VESA 100-200-300), providing an ergonomic and space-efficient solution for digital collaboration.

### + Occupancy light

An external indicator light that signals when the pod is in use. The light glows red when the pod is occupied and turns off when it is available.

### + LAN cable cat. 6a

A high-performance Ethernet cable that enables stable, high-speed internet connectivity, ensuring seamless communication and efficient workflow.

### + LED light 3000 K

A warm lighting option that enhances the ambiance, creating a cozy and inviting atmosphere inside the pod.

### + Control panel

A user-friendly interface that allows easy adjustment of lighting and ventilation, ensuring a personalized and comfortable workspace tailored to individual preferences.

### + Casters

Casters that provide effortless mobility, allowing the pod to be easily repositioned. When casters are installed, the pod's total height increases by 36 mm (1.4 in.).

# Equipment dimensions and weight

## TABLETOP

Width	600 mm (24 in.)
Depth	855 mm (34 in.)
Height	734 mm (29 in.)
Weight	6 kg (13 lbs)
Total load	20 kg (44 lbs)

## DISPLAY RAIL

Width	838 mm (33 in.)
Height	75 mm (3 in.)
Weight	1,4 kg (3 lbs)

## MONITOR HANGER (ADDITIONAL)

Width	838 mm (33 in.)
Height	429 mm (17 in.)
Total load	50 kg (110 lbs)

# Add-on sets

## Library set

Weight: 6,5 kg (14 lbs) | With packaging: 8 kg (18 lbs)

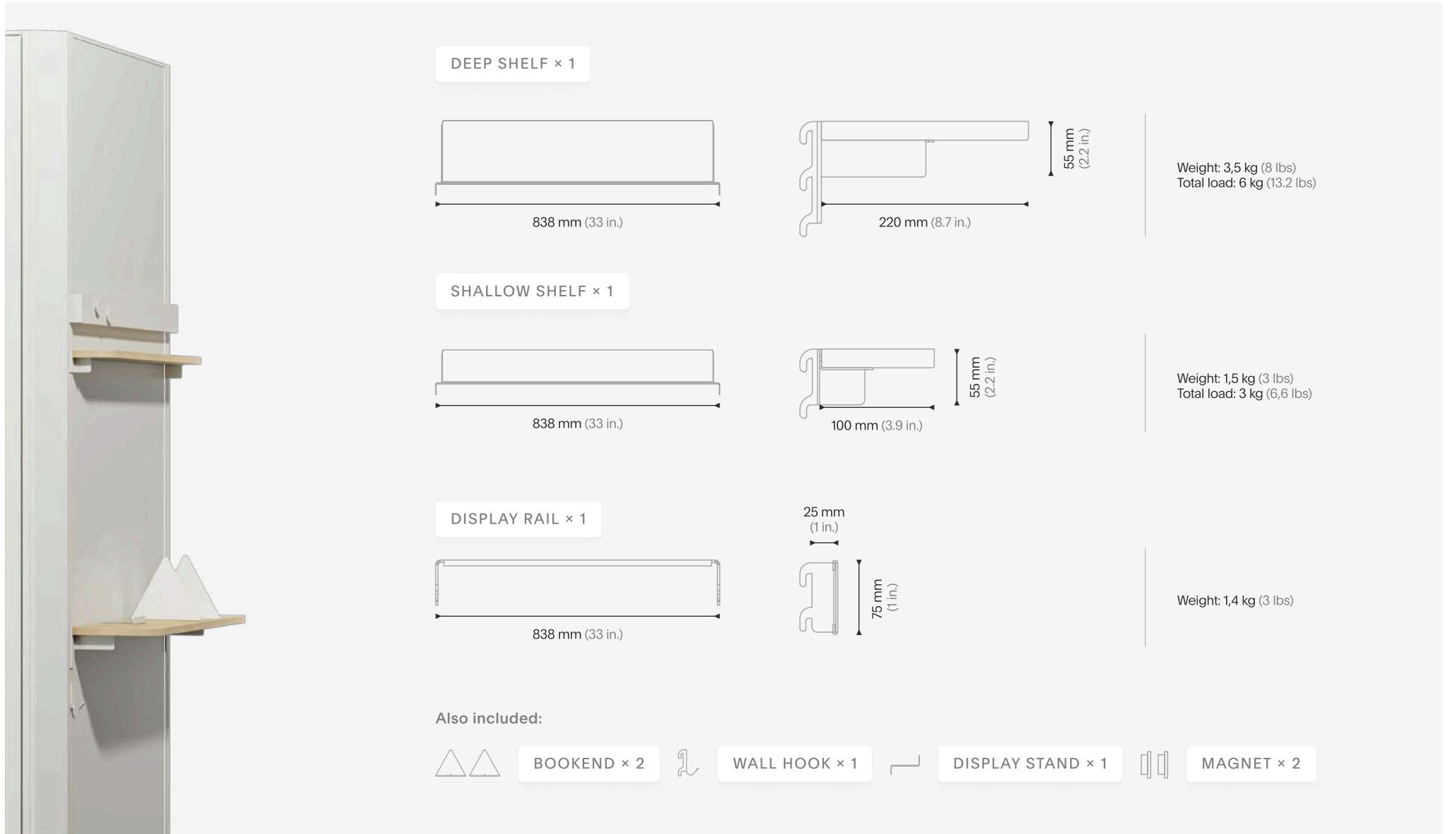

**DEEP SHELF × 1**

838 mm (33 in.)

220 mm (8.7 in.)

55 mm (2.2 in.)

Weight: 3,5 kg (8 lbs)  
Total load: 6 kg (13.2 lbs)

**SHALLOW SHELF × 1**

838 mm (33 in.)

100 mm (3.9 in.)

55 mm (2.2 in.)

Weight: 1,5 kg (3 lbs)  
Total load: 3 kg (6,6 lbs)

**DISPLAY RAIL × 1**

838 mm (33 in.)

25 mm (1 in.)

75 mm (1 in.)

Weight: 1,4 kg (3 lbs)

Also included:

BOOKEND × 2

WALL HOOK × 1

DISPLAY STAND × 1

MAGNET × 2

## Note set

Weight: 10 kg (22 lbs) | With packaging: 12 kg (26 lbs)

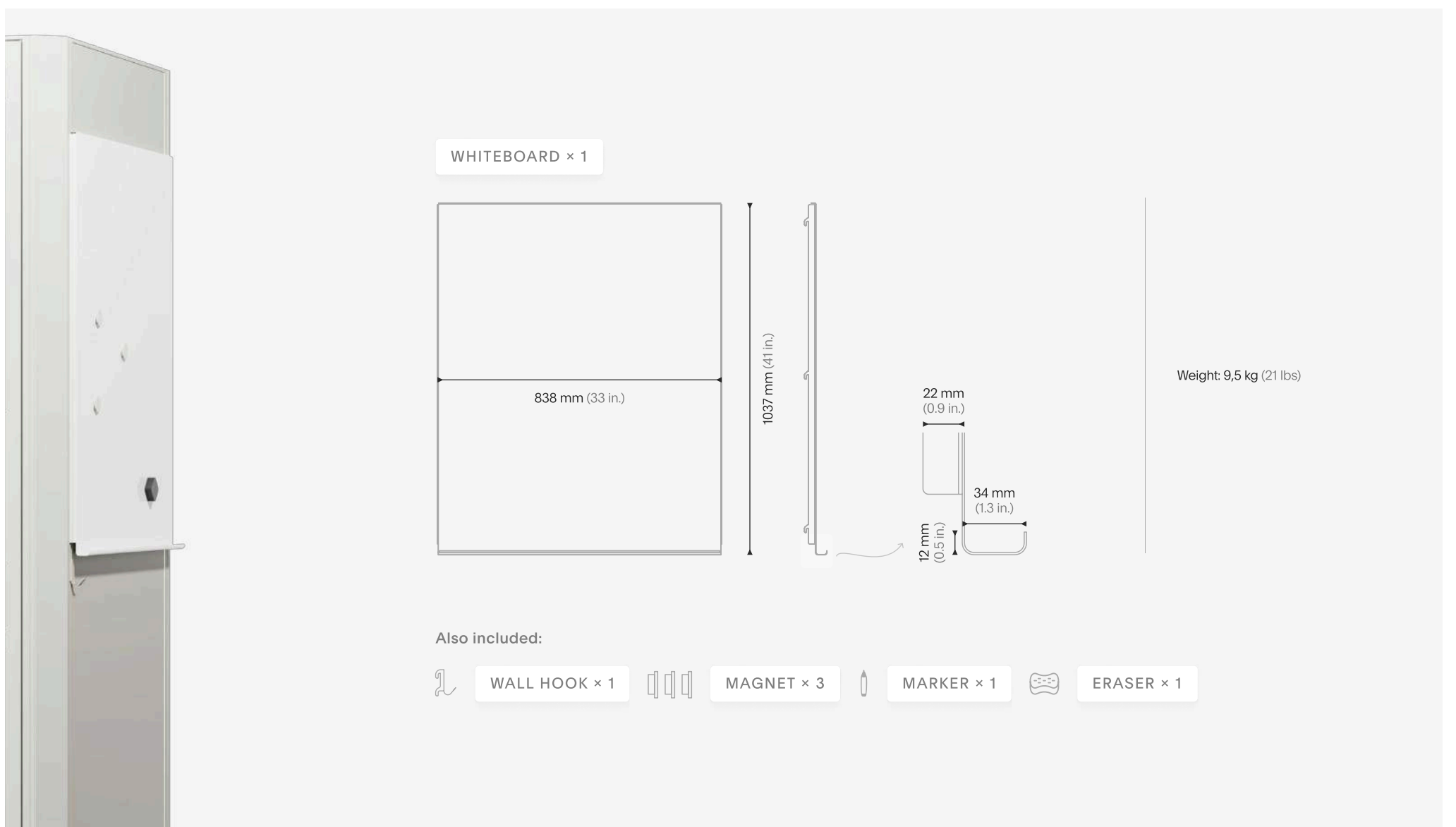

**WHITEBOARD × 1**

838 mm (33 in.)

1037 mm (41 in.)

22 mm (0.9 in.)

34 mm (1.3 in.)

12 mm (0.5 in.)

Weight: 9,5 kg (21 lbs)

Also included:

WALL HOOK × 1

MAGNET × 3

MARKER × 1

ERASER × 1



# Finishes overview



## 1 EXTERIOR WALLS - MELAMINE

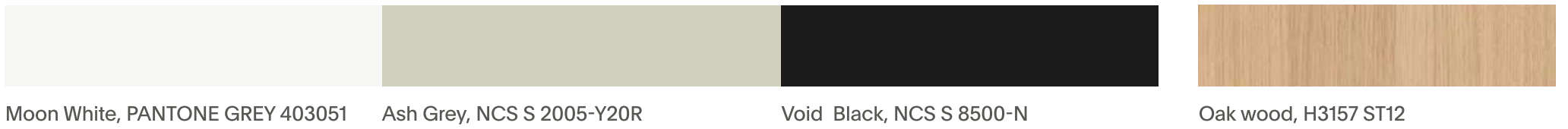

## 2 FRAME - ALUMINUM

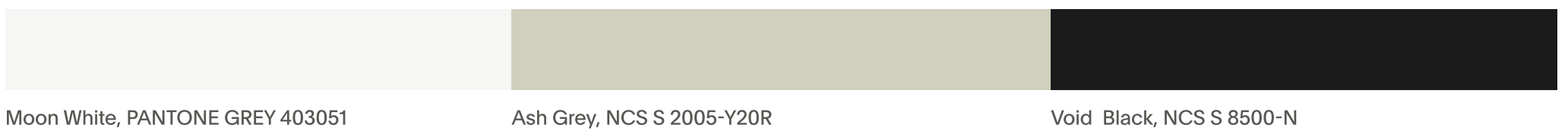

## 3 INTERIOR WALLS AND CEILING



## 4 TABLETOP AND SHELVES

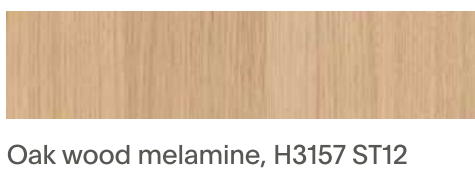

## 5 BOOKENDS AND MAGNETS



## 6 FLOOR

